

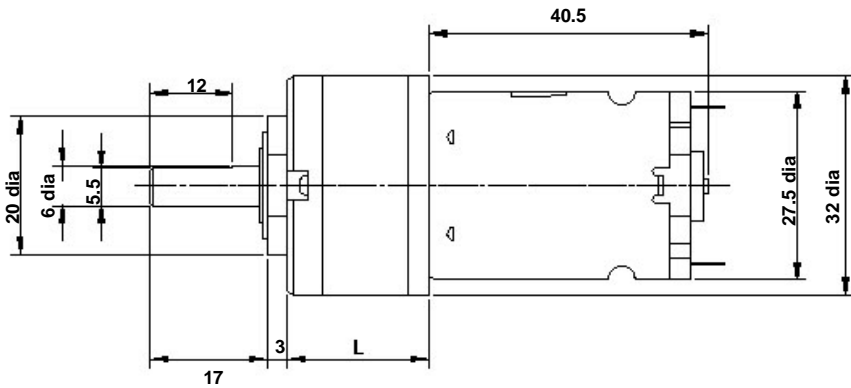

JPR Electronics Ltd
 Unit 4, Circle Business
 Centre, Blackburn Road
 Dunstable
 Beds
 LU5 5DD
 United Kingdom

Tel: (44) 01582 470000
 Web: www.jpreelec.co.uk
 Email: sales@jpreelec.co.uk

940D SERIES 32mm dia EPICYCLIC GEARED MOTOR DATASHEET

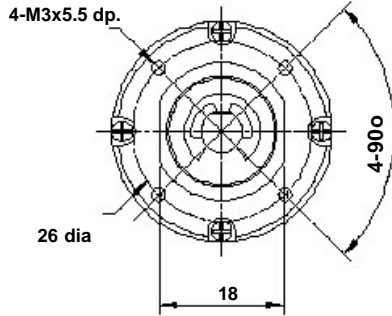

Pt. No. 727/1
 Geared motor bracket (90 degree)

RATIO	L
5:1	20.6
27:1	27.0
51:1	33.4
71:1	33.4
100:1	33.4
139:1	33.4
264:1	39.8
516:1	39.8
721:1	39.8
939:1	39.8

NOTE: all diameters in mm

MOTOR DATA. (RE-385)

MODEL	VOLTAGE		NO LOAD		AT MAXIMUM EFFICIENCY					STALL TORQUE		
	OPERATING RANGE	NOMINAL	SPEED	CURRENT	SPEED	CURRENT	TORQUE		OUTPUT	EFF	TORQUE	
			R.P.M.	A	R.P.M.	A	oz-in	g-cm	W	%	oz-in	g-cm
RE-385	6 - 15	12v Constant	11646	0.18	9869	0.99	1.09	78.4	7.85	66.1	7.13	513.5

Stall Current RE-385 at 12v = 4.62A

GEARBOX SPECIFICATIONS

Reduction ratio	Rated tolerance torque	Max momentary tolerance torque	Efficiency
1/5	2.0 kgf-cm Max.	6.0 kgf-cm	80%
1/14, 1/19	4.0 kgf-cm Max.	12.0 kgf-cm	70%
1/27, 1/35	6.0 kgf-cm Max.	18.0 kgf-cm	70%
1/51, 1/71	8.0 kgf-cm Max.	24.0 kgf-cm	60%
1/100	10.0 kgf-cm Max.	30.0 kgf-cm	60%
1/139	10.0 kgf-cm Max.	30.0 kgf-cm	60%
1/189	12.0 kgf-cm Max.	36.0 kgf-cm	50%
1/264	12.0 kgf-cm Max.	36.0 kgf-cm	50%
1/516	12.0 kgf-cm Max.	36.0 kgf-cm	50%
1/721	12.0 kgf-cm Max.	36.0 kgf-cm	50%
1/939	12.0 kgf-cm Max.	36.0 kgf-cm	50%

Gearbox Housing material	Metal
Backlash at no-load	≤ 2.5°
Bearing at output	Sleeve bearings
Radial load (10mm from flange)	≤ 3 kgf
Shaft axial load	≤ 2.5 kgf
Shaft press fit force max	≤ 10 kgf
Radial play of shaft	≤ 0.08mm
Thrust play of shaft	≤ 0.3mm

REDUCTION TABLE. R.P.M. (NO LOAD)

SUPPLY VOLTAGE	4.5v	6v	9v	12v	15v
940D51	873	1165	1747	2329	2912
940D271	162	216	324	431	539
940D511	86	114	171	228	285
940D711	61	82	123	164	205
940D1001	44	58	87	116	146
940D1391	31	42	63	84	104
940D2641	17	22	33	44	55
940D5161	8	11	17	23	28
940D7211	6	8	12	16	20
940D9391	4.7	6.2	9.3	12.4	15.4

Note: Motor speeds may vary by (+) or (-) 12.5%

WEIGHT	
940D51	167g
940D271	187g
940D511	213g
940D711	207g
940D1001	211g
940D1391	211g
940D2641	236g
940D5161	239g
940D7211	235g
940D9391	239g

GEARED MOTOR TORQUE RATINGS AT MAX. EFFICIENCY.

	At 12v (g.cm)
5:1	314
27:1	1482
51:1	2399
71:1	3340
100:1	4704
139:1	6539
264:1	10349
516:1	12000
721:1	12000
939:1	12000

NOTE: To establish Torque Rating in Nm, divide g.cm by 10,197.0

IMPORTANT NOTICE

At very low ratios the torque produced by this geared motor combination may exceed the maximum permissible torque of the gearbox. In this situation the unit must not be allowed to stall as this may damage the gears.

IMPORTANT NOTICE

Due to the wide range of applications for this product it is the users responsibility to establish the products suitability for their individual purpose(s).

ACCESSORIES



Part No. 1071.
M3 Anti vibration mount. 9g
Part No. 1072
M4 Anti vibration mount. 30g

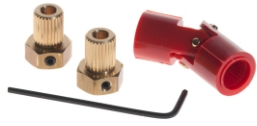

Universal Couplings. 12.5mm dia. 44mm length. **Part No. 1105/60.** 6mm - 6mm. See Page 63 for full range of combinations



Part No. 917D2515. "O" Ring
70mm x 5mm Dia. 5g



Part No. 919D1. In-Line
Coupling. 6mm - 6mm. (Dia.
12.67mm x 24.8mm). 23g



Part No. 919D1/2. In-line
Coupling. 6mm-8swg (Meccano)
Dia. 10mm x 20mm. 23g



Part No. 919D1/8. In-line
Coupling. 8mm-8mm
Dia. 12.67mm x 24.8mm. 23g



Part No. 919D2. Voltage
Regulator. (6-15v DC Input.
4v-12v output). 26mm x
31mm x 15.5mm. 30g



Part No. 919D4. Pulley
25mm dia. (Aluminium).
10g



Part No. 919D5. Pulley
16mm dia. (Aluminium). 4g



Part No. 919D24. Bevel
Gearbox. (Right Angle).
42g



Part No. 919D25. Nylon Bevel
Gears 1:1. OD30.7mm ID 6mm.
Module 1.0. 6g



Part No. 919D26
Stainless Steel shaft 5mmOD x 150mm. 23g
Part No. 919D26/1
Stainless Steel Shaft 6mmOD x 150mm. 36g
Part No. 919D26/2
Stainless Steel Shaft 8mmOD x 150mm. 59g



Part No. 919D27. Gear
Adapter.
6mm bore. M10 thread. 12g



Bearing Blocks
Part No. 919D30
5mm I.D.
(19.06 x 19.0mm x 10mm) 32g
Part No. 919D30/1
6mm I.D.
(20 x 20mm x 12.5mm) 32g
Part No. 919D30/2
8mm I.D.
(19.0 x 19.0mm x 13.0mm) 32g

MOTOR DATA. (RE-385)

MODEL	VOLTAGE		NO LOAD		AT MAXIMUM EFFICIENCY						STALL	
	OPERATING RANGE	NOMINAL	SPEED	CURRENT	SPEED	CURRENT	TORQUE		OUTPUT	EFF	TORQUE	
			R.P.M.	A	R.P.M.	A	oz-in	g-cm	W	%	oz-in	g-cm
RE-385	6 - 15	12v Constant	11646	0.18	9869	0.99	1.09	78.4	7.85	66.1	7.13	513.5

Stall Current RE-385 at 12v = 4.62A

